

**ARROWHEAD PLAZA**  
1138A N 3<sup>rd</sup> St – Bismarck ND

- Lease Rate  
\$11.50 psf + utilities  
\$2,875 per mo
- Lease Space  
3,000 sf
- 3 Year Lease Minimum
- Central Location
- Ample Parking
- Annual Real Estate  
Tax Escalator

**Contact Information:**

**Bill Daniel, CCIM**  
701.220.2455  
Bill@DanielCompanies.com

**Kyle Holwagner, CCIM**  
701.400.5373  
Kyle@DanielCompanies.com

**Ann Sharp**  
701.220.0261  
Ann@DanielCompanies.com

**Daniel Companies**  
304 E Rosser Ave Suite 200  
Bismarck ND 58501  
701.223.8488  
701.223.8860 fax

**DanielCompanies.com**

Broker does not guarantee the information describing this property. Interested parties are advised to independently verify the information through personal inspectors or with appropriate professionals.



The Leader In Commercial

## **Arrowhead Plaza** **Bismarck's Convenient Place for Business**

- **Area Businesses**
  - Plaza Beer Depot
  - Plaza Barber Shop
  - Plaza Drug
  - Plaza Hair Center
  - Dan's SuperMarket
  - The Walrus
  - Arrowhead Cleaners & Laundry
  - US Bank
  - Arrowhead Tesoro
  
- **Centrally Located Near**
  - State Capitol Complex
  - Downtown
  - Tom O'Leary Golf Course
  - Waling path
  - Schools
  - churches
  
- **Area Businesses**
  - Retail
  - Medical uses
  - Services
  - Professional office

Broker does not guarantee the information describing this property. Interested parties are advised to independently verify the information through personal inspectors or with appropriate professionals.





The Leader In Commercial

## Former Check Into Cash Space

- Located between
  - The Walrus
  - Arrowhead Cleaners & Laundry
- Great synergy with current tenant mix
- Two restrooms
- Alley delivery access
- Annual real estate tax escalator

## Demographics

	<u>3 Miles</u>	<u>5 Miles</u>	<u>10 Miles</u>	<u>MSA</u>
Population	12,784	57,316	72,356	104,944



**Space Available**

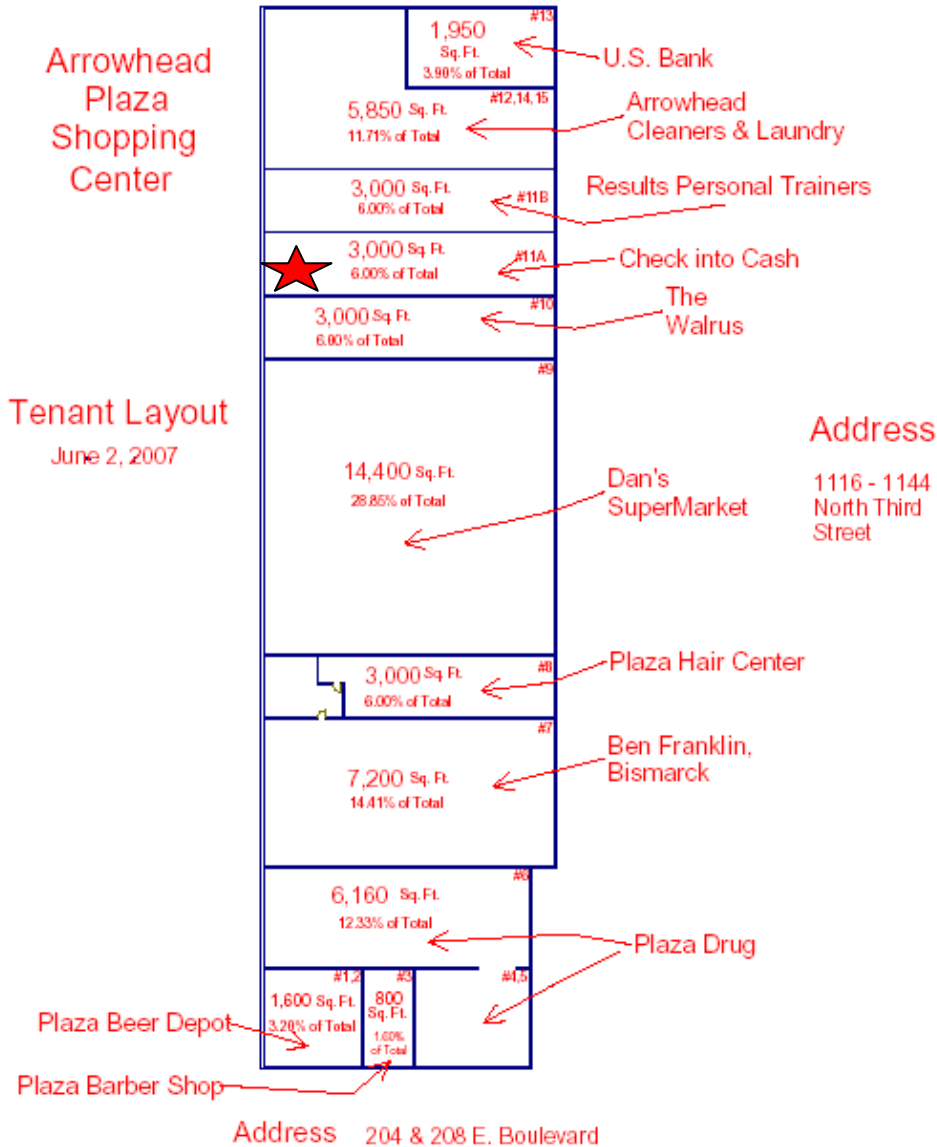

Arrowhead Tesoro  
(Service Station)



**Space Layout**

**Arrowhead Plaza Shopping Center**

3,000 sq. ft.

Check Into Cash

25' X120'

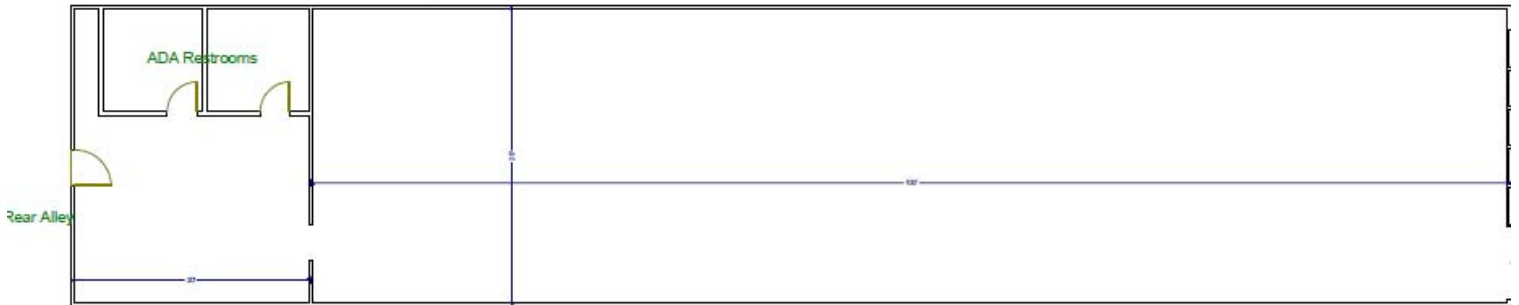

Basic Layout

Not to Scale

Broker does not guarantee the information describing this property. Interested parties are advised to independently verify the information through personal inspectors or with appropriate professionals.





The Leader In Commercial





The Leader In Commercial



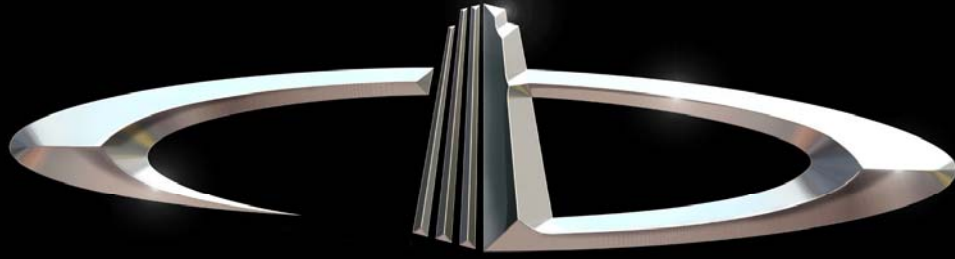

# DANIEL COMPANIES

The Leader in Commercial Real Estate

Serving commercial real estate customers with unmatched market knowledge, experience, and well-deserved reputation for integrity.

They know the Bismarck-Mandan commercial real estate market better than anyone. This powerful team delivers powerful results



**Bill Daniel, CCIM**  
220-0261



**Kyle Holwagner, CCIM**  
400-5373



**Ann Sharp, GRI**  
220-0261

304 E. Rosser Ave., Suite 200 Bismarck, ND 58501

Office: 701-223-8488 [DanielCompanies.com](http://DanielCompanies.com)

RETAIL • INVESTMENTS • OFFICE • INDUSTRIAL • SITE SELECTION • LEASING • BUILD TO SUIT • BROKERAGE